



INSTRUCTIONS

-J00438

REV. 9-17-99

Kit Numbers 69000-76 ,69016-76, 69000-76A, and 69016-76A

HORN - FL, FX, XL, CR MODELS

General

This horn is the standard replacement unit for the models listed above. Also included is one crimpnut used for securing chrome cover to horn. Installation is basically the same for all models, but varies slightly on FL models.

For FL Models -

The standard horn is located inside the headlamp housing on early FL models. On late model FL's the horn is located on the left side of the engine. To remove horn, remove headlamp molding and headlamp assembly from housing. Remove bolt that holds horn bracket in place; disconnect horn wire and remove horn assembly. Save all removed hardware.

For FX, XL, CR Models -

Locate and remove nut that holds horn assembly to left side of engine. Disconnect horn wire and remove horn assembly. Note that some models have a fuel line guide assembled to horn, and some models have a rubber bumper attached to horn. These parts must be removed and retained for reinstallation when removing horn.

All Models -

Remove old horn from mounting plate.

Treat threads on new horn with Loctite threadlocker part number 99642-97. Assemble new horn to mounting plate, being sure to reinstall fuel line guide or rubber bumper as required.

Remove chrome cover (if equipped) from old horn (all models but FL, FLH) and save removed hardware. Position cover on new horn and secure at upper cover ear (1) with nut, lockwasher, and screw. Install screw, spacer, washer, and nut at lower hole (2). Note that spacer must be installed between horn and horn cover as shown.

The special crimpnut supplied is used at upper hole (3) in place of the original speed nut. Insert crimpnut in horn cover. Install screw into nut and tighten until cover is secured to horn.

Reinstall horn assembly and replace headlamp assembly on FL models. Connect horn wire.

If horn fails to blow or does not blow satisfactorily, check for loose or frayed wires or a discharged battery. If this does not correct the problem, turn the adjusting screw located on back of horn IN until horn gives just a single click; then back screw out until best tone is obtained.

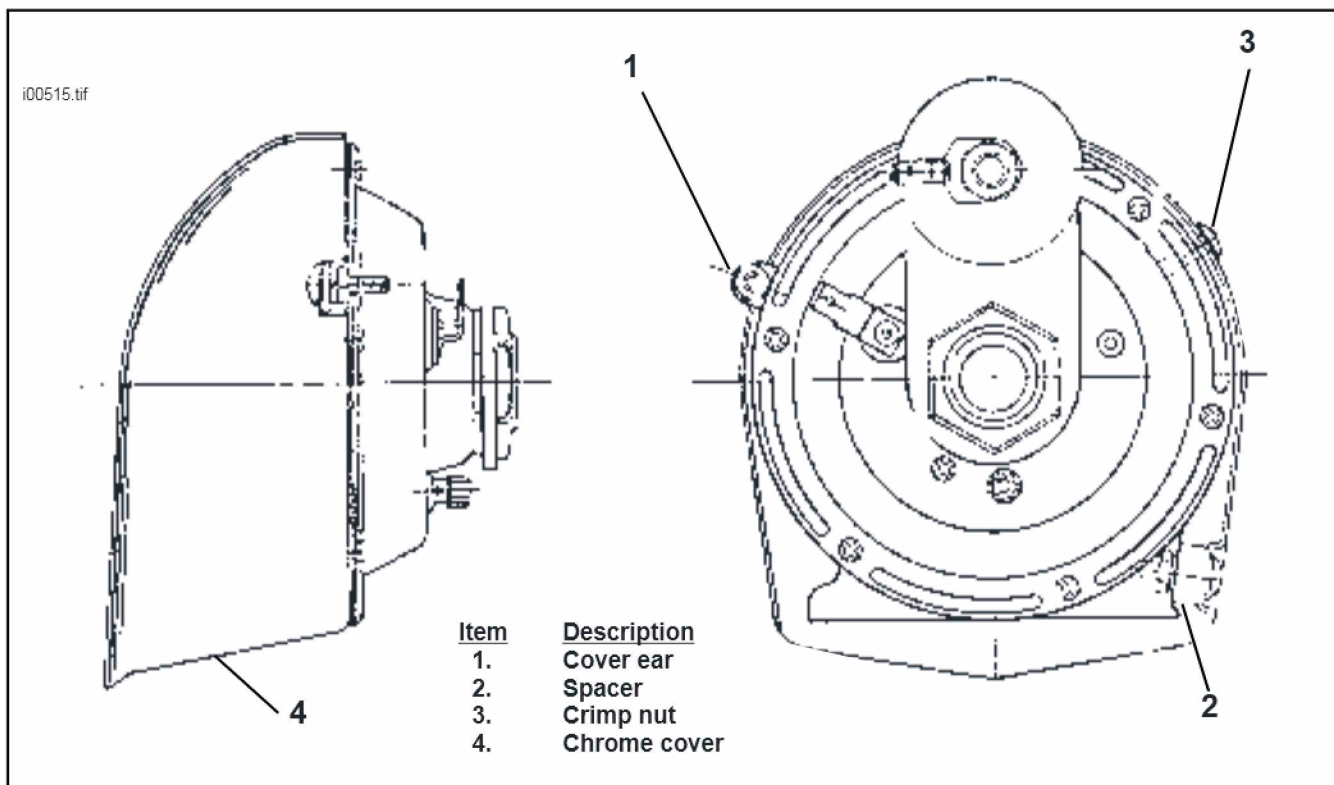

Horn Assembly