



INSTRUCTIONS

-J01194

REV. 1-30-98

Kit Number 65127-98

SPORTSTER CHROME MUFFLER SUPPORT

General

This kit fits 1986 and later Sportster models. See Service Parts illustration below for items in this kit.

Installation

1. Loosen or remove heat shield on rear exhaust pipe, as necessary, by opening worm drive clamps that hold heat shield in place. Loosen nut on rear muffler clamp.
2. Remove hardware that attaches rear muffler bracket to support tube (a screw, washer, and nut) and save nut for reassembly.
3. Remove hardware that attaches support tube to motorcycle (2 screws and 2 washers) and save hardware for reassembly.
4. See Service Parts illustration. Position chrome support tube (1) on frame and install support tube screws and washers saved from step 3. Tighten screws to 33 ft-lbs (45 Nm).
5. Attach rear muffler bracket to chrome support tube with chrome washer (2), chrome screw (3), and nut saved from step 2. Do not tighten screw.
6. Align rear muffler. Tighten muffler clamp to 45-60 ft-lbs (61-81 Nm).
7. Tighten hardware that attaches muffler bracket to chrome support tube to 19 ft-lbs (26 Nm).
8. If heat shields were removed or loosened, secure them in place.



Service Parts

Part No. 65127-98

Date 1/98

Sportster Chrome Muffler Support

i01143

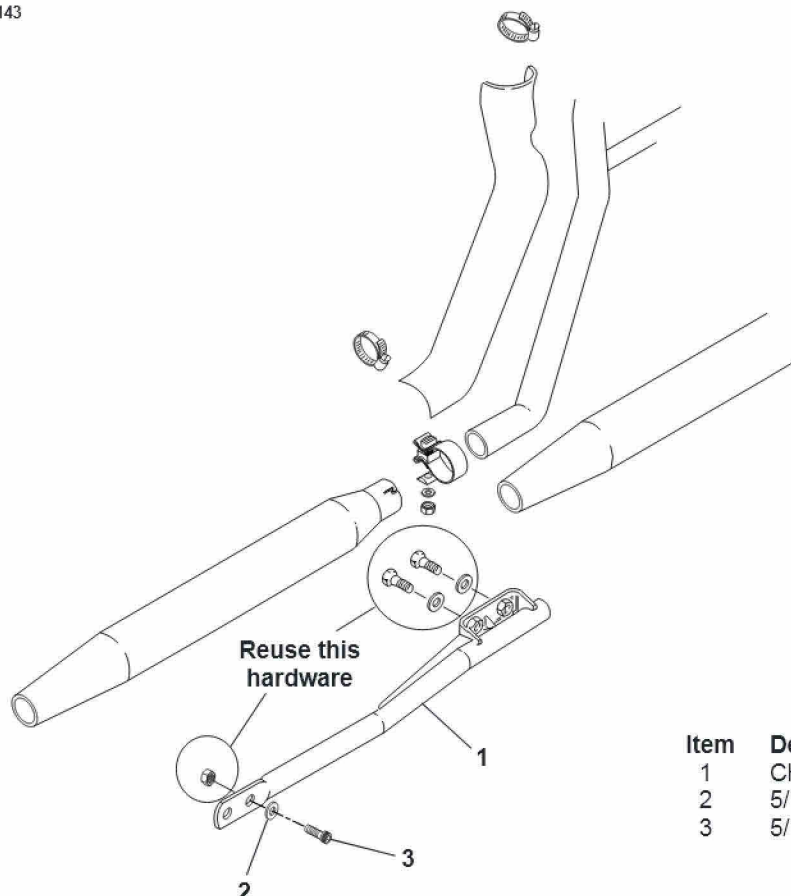

Item	Description	Part No.
1	Chrome rear muffler support	not sold
2	5/16 Washer	94066-90T
3	5/16-18 x 3/4 in. long screw	94332-91T